



GENERAL INFORMATION

Type of Vessel	Multi Role Survey
Year of Build	1984
Reconfigured	2007
Flag	UK
Port of Registry	Lowestoft
Call Sign	GDLS
IMO Number	8207941
MMSI Number	235011460
Owner & Operator Information	GARDLINE LTD
Classification Society	DNV

CAPACITY

Fuel Oil Capacity	431.2 m ³
Freshwater Capacity	73.98 m ³
Ballast Water Capacity	527.0 m ³

DIMENSIONS

Length Overall (m)	69.3
Breadth (beam) (m)	14.4
Depth (m)	7.65
Draft (m)	4.1 - 4.6
Air Draft (m)	20.2
GT (t)	1936
NT (t)	580

MACHINERY AND PERFORMANCE

Main Engine(s) Type and Power output	Mirrlees Blackstone ESL Mk 2
Propulsion System	1x Fixed Pitch Propeller 1x Gilljet Bowthruster
Auxillary Engines	Mirrlees Blackstone MB 275
Speed	Eco 8 kts Max 10 kts Transit 9 kts

ACCOMMODATION

Accommodation: Nos. of Cabins	
Single	39
Double	0
Additional	1 x Hospital
Total Berths	40
Laboratories	Survey Lab
Workspaces for Onboard Data	Processing Rooms
Interpretation / Office	
Passenger Capacity	Nil
Facilities Available	Gym, TV Lounge

SAFETY

Lifeboats and Life Rafts	6x inflatable liferafts (20 pax)
Firefighting Equipment	SOLAS-compliant FFE
Pollution Prevention	MARPOL-compliant SOPEP

NAVIGATION AND COMMS

Advanced Radar Systems	Sperry VisionMaster FT x2
Positioning / Nav Systems	Furuno GP-170 GPS
Comm Equipment	Sailor (VHF DSC, MF/HF DSC & SAT-C) (VHF, HR, SATCOM)
AIS	Furuno FA-150 AIS

SURVEY EQUIPMENT

Piston Corers	Kullenberg type 3/5/6m
Visual Sampling	Shallow Water Camera, Freshwater Lens Camera Deep Water Camera
Grab Sampling	Day Grab, Mini Hamon Grab, Double Van Veen Grab, Van Veen Grab, UNSEL Box Corer, Shipek Grab
Water Sampling	Rosette Sampler, Niskin Bottles, Plankton vertical trawl, CTD
PAMS	Gardline MK3 PAM System
SBES	Kongsberg EA400
MBES	EM2040, 0.4 x 0.7 dual Rx 400kHz shallow water
SSS	Edgetech 4205 - Multiple Frequencies
SBP	19 Element Hull Mounted Pinger, INNOMAR 2000 Medium
Magnetometers	Geometrics G882 Magnetometer
UXO	UXO TVG, UXO dual EIVA Scanfish, ROTV with 4x magnetometers
UHR Seismic Streamer	Geometrics GeoEEL 3.125m (8/16/24/32) Channel (max 100m), EHRS 1m group 96 Channel System, 2D or 3D multiple streamers, dual source

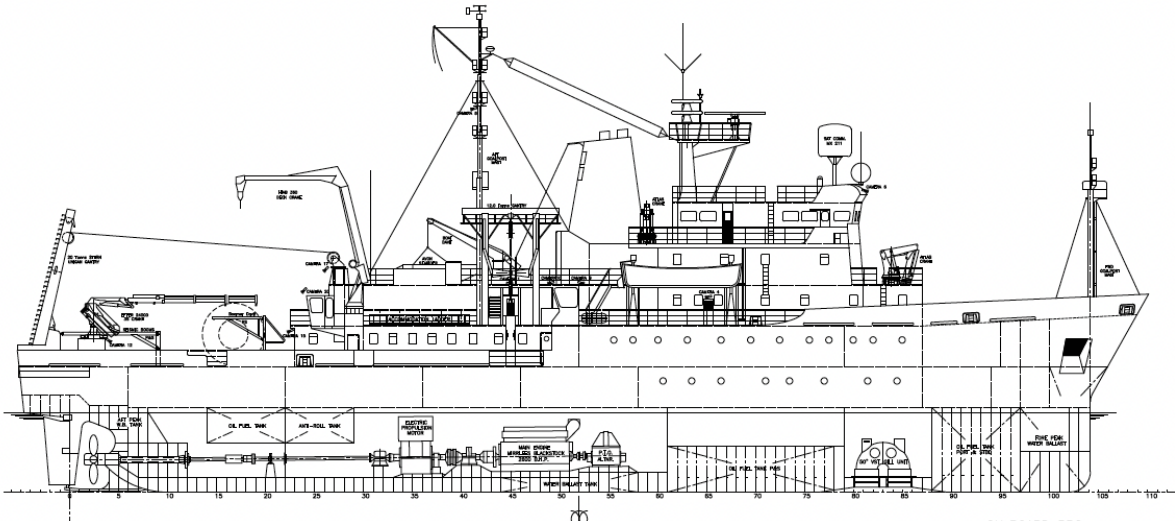

SIDE VIEW - PORT SIDE

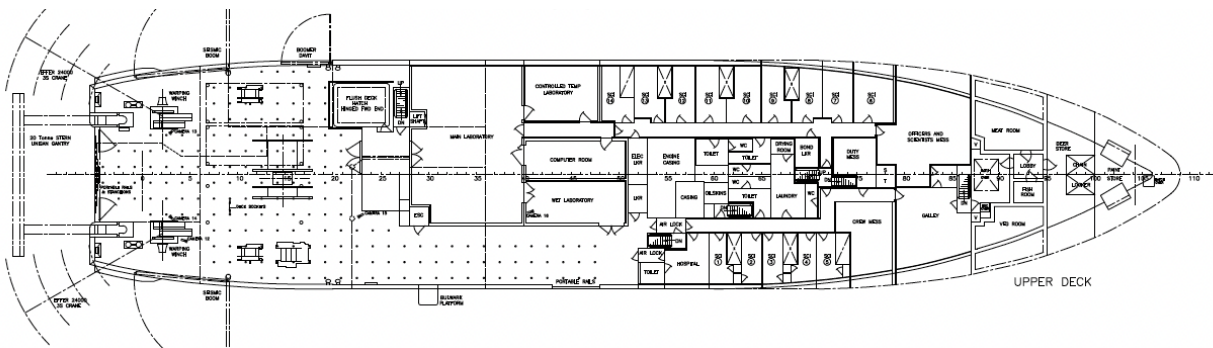

TOP VIEW - DECK LEVEL